

All Events Are In Henry B. Gonzalez Convention Center Unless Noted Otherwise.

Delegates must display conference registration badges and tickets, if required by event, for admittance to all conference functions; delegates are expected to comply with stated AWBD policy of expected behavior at AWBD functions.

Registrations/Tickets are non-transferable. Guests are not admitted to nor permitted to attend Delegates Only functions, such as continental breakfasts, coffee breaks, luncheon, or seminars.

Children will not be admitted in the conference areas.

TOPICS & SPEAKERS SUBJECT TO CHANGE

2025 AWBD SUMMER CONFERENCE PROGRAM SCHEDULE

Henry B. Gonzalez Convention Center

Thursday 6/12/25

12:30 p.m.	Conference Shuttle Bus Service Begins	Hotel Loop
1:00 p.m.	Conference Check-In Opens	Exhibit Hall 4 Foyer
	Exhibitors Open Meet the Candidates Booth Opens	Exhibit Hall 4
	AWBD Garage Sale Opens AWBD Ambassadors Table Opens AWBD Emerging Leaders Table Opens	West Registration
5:30 p.m. – 7:00 p.m.	Welcome Reception (One guest per registered delegate; advance guest registration required; no guests will be registered at the conference; no children permitted)	Exhibit Hall 4
7:00 p.m.	Conference Check-In Closes	Exhibit Hall 4 Foyer
	Exhibitors Close Meet the Candidates Booth Closes	Exhibit Hall 4
	West Registration Closes	West Registration
7:30 p.m.	Conference Shuttle Bus Service Stops	Hotel Loop

Friday 6/13/25 - DELEGATES ONLY

7:30 a.m.	Conference Shuttle Bus Service Begins	Hotel Loop
8:00 a.m.	Conference Check-In Opens	Exhibit Hall 4 Foyer
	Exhibitors Open	Exhibit Hall 4
	Polls Open AWBD Garage Sale Opens AWBD Ambassadors Table Opens AWBD Emerging Leaders Table Opens	West Registration
8:00 a.m. – 8:45 a.m.	Continental Breakfast (Delegates Only) Delegates only will be admitted to the continental breakfast; no guests will be allowed in this area or at this function. <i>Complimentary Beverage Service For Delegates Only Throughout Day</i>	Exhibit Hall 4
8:45 a.m. – 9:45 a.m.	General Session & Candidate Speeches	Hemisfair Ballroom, FLR 3
<i>Special Presentation:</i> “Gone in 60 Seconds - Cyber Fraud Update” <i>Immediately following General Session</i>		
10:00 a.m. – 11:00 a.m.	SEMINAR I – Legislative Update	Hemisfair Ballroom, FLR 3
11:15 a.m. – 12:15 p.m.	SEMINAR BLOCK II	
Session A	811, “Can You Dig It?”	Lila Cockrell Theatre, FLR 1
Session B	Real Estate Basics for Directors - What’s An Easement, And Why Do I Care?	Room 214, FLR 2
Session C	Every Drop Counts: Ensuring Water Accountability	Room 217, FLR 2
12:30 p.m. – 1:45 p.m.	EXHIBITOR LUNCHEON (<i>Delegates Only</i>) <i>Delegates must present ticket for admission.</i>	Exhibit Hall 4
2:00 p.m. – 3:00 p.m.	SEMINAR BLOCK III	
Session A	Identifying and Characterizing Water Quality Issues Using Geochemical Modeling	Lila Cockrell Theatre, FLR 1
Session B	Hit It Out of The Park: Reimagining Parks for Community Value	Room 214, FLR 2
Session C	Citizen Response To An Active Shooter Event	Room 217, FLR 2
2:30 p.m.	Conference Check-In Closes	Exhibit Hall 4 Foyer

Friday 6/13/25 cont. - DELEGATES ONLY

2:30 p.m.	Exhibitors Close	Exhibit Hall 4
	Polls Close West Registration Closes	West Registration
3:30 p.m.	Conference Shuttle Bus Service Ends	Hotel Loop

Saturday 6/14/25 - DELEGATES ONLY

7:30 am	Conference Shuttle Bus Service Begins	Hotel Loop
8:00 a.m.	Conference Check-In Opens AWBD Garage Sale Opens AWBD Ambassadors Table Opens AWBD Emerging Leaders Table Opens	West Registration
8:00 a.m. – 8:45 a.m.	Continental Breakfast (Delegates Only) Delegates only will be admitted to the continental breakfast; no guests will be allowed in this area or at this function. <i>Complimentary Beverage Service For Delegates Only Throughout Day</i>	Exhibit Hall 4
9:00 a.m. – 10:00 a.m.	SEMINAR BLOCK IV – Current Texas Demographics	Hemisfair Ballroom, FLR 3
10:15 a.m. – 11:15 a.m.	SEMINAR BLOCK V	
Session A	Managing Water Infrastructure: A Collaborative Approach	Lila Cockrell Theatre, FLR 1
Session B	From Inspection To Perfection: Building A Cost-Efficient Asset Management Program Around Annual Water Plant Inspections	Room 214, FLR 2
Session C	Ethics: How To Stay Out of the MUD	Room 217, FLR 2
11:30 a.m. – 12:30 p.m.	SEMINAR BLOCK VI	
Session A	The Future's Flowing: How AI Is Shaping The MUD World – Part 1	Lila Cockrell Theatre, FLR 1
Session B	A Comprehensive Look At Flock Camera Systems	Room 214, FLR 2
Session C	Crystal Clear: Understanding Consumer Confidence Reports	Room 217, FLR 2

Saturday 6/14/25 cont. - DELEGATES ONLY

12:00 p.m.	Conference Check-In Closes	Exhibit Hall 4 Foyer
	West Registration Closes	West Registration
12:45 p.m. – 2:00 p.m.	AWARDS CLOSING LUNCHEON <i>(Delegates Only)</i> <i>Delegates must present ticket for admission.</i>	Hemisfair Ballroom, FLR 3
2:30 p.m.	Conference Shuttle Bus Service Ends	Hotel Loop

Thank You To Our Sponsors!!



COFFEE BREAK SPONSOR

Civil Grade Engineers
Thursday, Friday, & Saturday



CONTINENTAL BREAKFASTS SPONSOR

Best Trash
Friday & Saturday



CONFERENCE HOTEL KEY SPONSOR

Magna Flow Environmental

EVENT MAPS

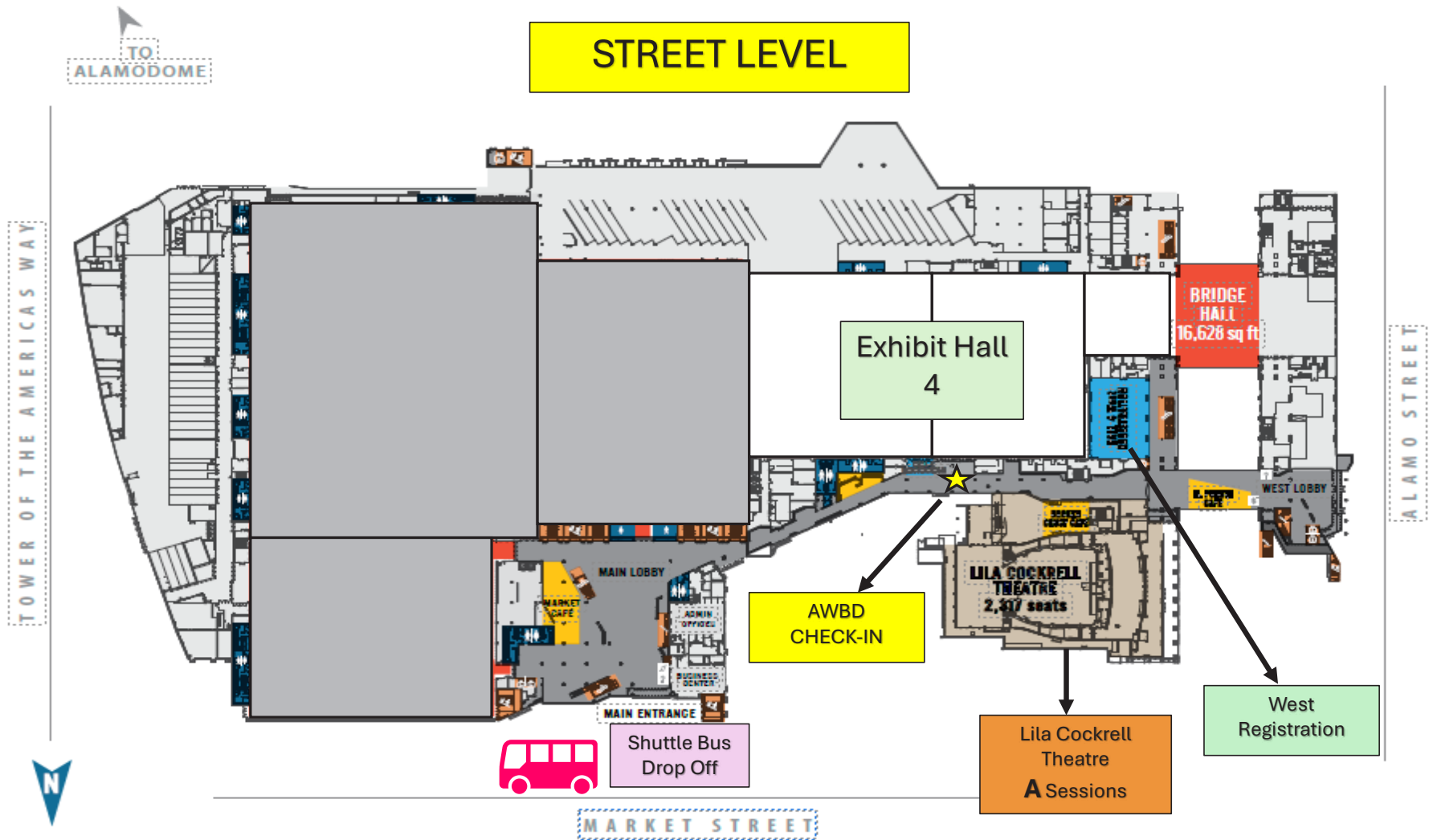

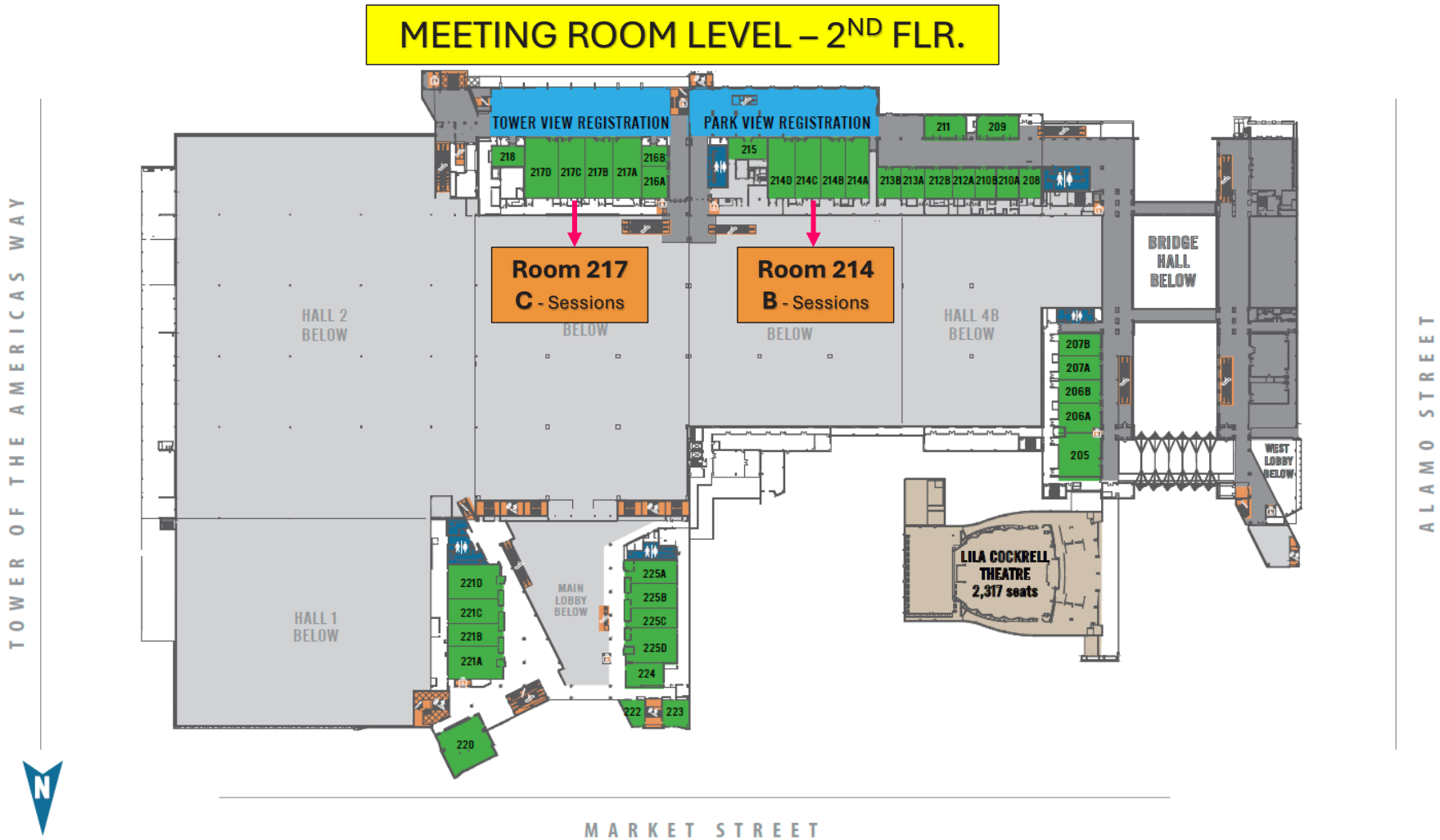

TOWER OF THE AMERICAS WAY



BALLROOM LEVEL – 3RD FLR.

